



**I S O M**

**IOWA SCHOOL OF MINISTRY**  
**ACADEMIC CATALOG 2012-2013**

 **iowa ministry network**  
ASSEMBLIES OF GOD  
10525 BUENA VISTA COURT  
URBAN DALE, IA 50322

A stylized graphic of three red, flame-like shapes rising from the bottom. The shapes are smooth, curved, and taper to points at the top. They are set against a white background.

**ACADEMIC CATALOG  
2012-2013**



# ENDORSEMENT

The Iowa School of Ministry has been recognized and endorsed by the Executive Presbytery Board of The General Council of the Assemblies of God as a District-based Bible Institute, and is a member of the District Schools of Ministry.

The Iowa School of Ministry has also been recognized and endorsed by the Executive Presbytery of the Iowa Ministry Network of the Assemblies of God as an official ministerial training program for those seeking credentials through the Iowa Ministry Network of the Assemblies of God.

# DISCLAIMER

Courses completed through the Iowa School of Ministry will be conducted and graded by the ISOM, and transcripts will be issued by the Iowa Ministry Network. You will not receive any credit from the Berean School of the Bible, nor will they provide you with any transcript for courses taken through the Iowa School of Ministry. This is a district-based school, and all authorization and credits will be handled through the Iowa Ministry Network.

Required credential courses completed through the Iowa School of Ministry meet the educational requirements of The General Council of the Assemblies of God for the respective level of credential. This does not, however, automatically mean that you will receive a credential with the Assemblies of God. Many other aspects enter into the granting of a credential, and those aspects must also be met before a credential will be granted. The credentialing process is separate from the completion of the educational requirements.

Additional booklets, enrollment and registration forms are available by calling our office at (515)276.5493 or online at [www.imnag.org](http://www.imnag.org).



# TABLE OF CONTENTS

Welcome .....	6
General Information .....	7
Statement of Purpose .....	7
Structure .....	7
Student Policies .....	8
Enrollment & Class Registration .....	9
Auditing Policy .....	9
Course Descriptions .....	10
Educational Requirements for Credentials .....	15
2011-2012 ISOM Schedule .....	16
ISOM Board .....	17
Directions to the Iowa Ministry Network Office .....	19
ISOM Testimonials .....	20



# WELCOME!

The Iowa School of Ministry (ISOM) exists to help individuals develop the skills, talents and knowledge necessary to fulfill God's calling on their lives. ISOM instructors invest their time and talents, giving students the benefit of their ministerial experience and knowledge. These men and women of God want you to benefit from their life experiences, which greatly enriches the learning environment.

Classes are designed to be interactive in order to engage and stimulate the retention of each individual. We hope that you will find a friendly and challenging environment, as well as a course of instruction giving you a practical and useful knowledge base that will enable your ministry to expand.

ISOM exists for the sole purpose of preparing both vocational ministers and lay leaders into the kingdom workers that God intended them to be!

Sincerely,

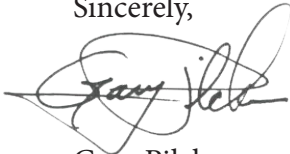
A handwritten signature in black ink, appearing to read "Gary Pilcher", written in a cursive style.

Gary Pilcher  
ISOM President



# GENERAL INFORMATION

ISOM is a vital support to the ministry endeavor of churches and pastors. Knowledge gleaned from the classroom experience becomes a valuable tool that the Holy Spirit can use to further the purpose of God. Clergy and laypersons who understand not only what to do, but why to do it will be far more effective than those who just do it.

ISOM integrates spiritual formation, relationship building and academic achievement to provide a unique learning experience. Students not only acquire knowledge necessary for obtaining ministerial credentials, but also develop character and skills essential for effective ministry.

## STATEMENT OF PURPOSE

The Iowa School of Ministry exists for the purpose of equipping spiritual leaders through academic development and encouraging relationships.

The school seeks to promote a unified purpose for ministry within the Fellowship, providing doctrinal and practical instruction based upon common core values and shared ministry goals.

The Iowa School of Ministry subscribes fully to the Statement of Fundamental Truths of the Assemblies of God and commits itself to proclaim and support the principles and policy of the Assemblies of God. Additionally, the school commits itself to provide training courses that meet district and General Council educational requirements for ministerial credentials.

## STRUCTURE

Classes are conducted nine times throughout the year, with three levels of courses offered during each session. Students participate in eight hours of classroom instruction, with a two-hour class session on Friday evening and six hours on Saturday. A final exam is taken and scored at the end of the final session.

Prior to class, each student is required to work through the course text overview. A minimum of ten to fifteen (10-15) hours of preparatory work is necessary. With the classroom time, students will have invested at least eighteen (18) hours per course.

The classroom instruction provides an overview of the material, practical applications and opportunity for questions and discussion. Instructors use personal experience and a variety of teaching methods.

Faculty members become natural mentors as they build relationship and share experiences with their students. Faculty advisors are available to provide accountability and guidance for the students.

# STUDENT POLICIES

- Students are required to register no less than three (3) weeks prior to the beginning of their chosen course.
- An additional \$15 will be charged for those registrations postmarked or received less than three (3) weeks prior to the scheduled ISOM class. If a husband and wife are both late, both will be assessed the additional \$15. It is the desire of the ISOM Board that you have ample time to properly prepare for your class, so that you will receive the full benefit of the instruction. No registration postmarked less than two weeks prior to class will be allowed.
- Written notification of withdrawal from class must be postmarked or received in the IMN office three (3) weeks prior to the first day of the scheduled ISOM class in order to receive a \$40 refund.
- Students are required to complete a minimum of ten to fifteen (10-15) hours of preparatory self-study in advance of the class session.
- Students are required to read course textbook(s) and to complete the course text overview prior to class.
- Students must complete all assignments required for the course prior to the class session, as per course syllabi.
- Students must attend all class sessions, complete the required assignments and successfully pass the course exam in order to receive credit for the course. (With some minor variations, the final grade will include the following components: 25% Pre-course work, 75% Final Exam. Students must receive at least 70% on the final exam to pass the course.)

# ENROLLMENT AND CLASS REGISTRATION

1. Contact the Iowa Ministry Network office for the enrollment form and the registration form if none are available in this booklet. These forms are also available to download from our website, [www.imnag.org](http://www.imnag.org). Please mail in your enrollment and the first class registration. After the initial registration, you may register for classes online.
2. Please send the completed enrollment form, with your signature and your lead pastor's signature, along with the one-time enrollment fee of \$25 and the completed class registration form, along with the \$80 class fee, to: Iowa Ministry Network, 10525 Buena Vista Court, Urbandale, IA 50322. Upon receipt of the necessary forms, your class material will be ordered for delivery to you.
3. A course syllabus will be mailed to you from our office.
4. Arrive for class at the IMN office by 6:15 PM on Friday evening prepared and ready to learn. Bring all corresponding assignments completed and ready for submission to the course instructor.
5. Online class registration is available at [www.imnag.org](http://www.imnag.org)
6. Group discount policy information is available upon request.

## AUDITING POLICY

- Ordained lead pastors may audit one ISOM class in a calendar year with no tuition charge (with the exception of any special sessions which would be at the regular tuition cost). If they wish, they may purchase the textbook at the regular rate.
- An ordained lead pastor who brings a new student may audit any ISOM class at a 50% tuition discount. The textbook may be purchased at the normally charged fee. The student must pay full tuition.
- ISOM alumni may audit any previously completed class for a \$10 audit fee (textbook will not be included).
- All auditors must attend the entire session and participate in the class session in the same way that a fully registered student would be expected to participate.

# COURSE DESCRIPTIONS

## BIBLE DIVISION

### CHRIST IN THE SYNOPTIC GOSPELS

An introductory study of our Lord's life and times according to the Gospels of Matthew, Mark and Luke. It examines the historical setting, His life between the Annunciation and the Ascension and His message and method, including his parables and miracles. Organized around these three themes: (1) the world, (2) the Man and (3) the message, this introduction helps to fuse our understanding of His life and work with our commitment to live by the values He taught and demonstrated.

### ACTS: THE HOLY SPIRIT AT WORK IN BELIEVERS

A thorough study of the content, purposes, principles and applications of Acts. The course emphasizes the role of the Holy Spirit in the early church and today. Attention is given to the geographical, numerical, cultural and theological growth of the church from Jerusalem to Rome. The journeys of Paul are examined as the background for his epistles.

### PRISON EPISTLES: EPHESIANS, COLOSSIANS, PHILIPPIANS, AND PHILEMON

A practical study of the principles Paul wrote to the churches during his imprisonment. The concepts are presented in a language that is easy to understand with explanations, illustrations and applications that make the concepts helpful to students in both their personal lives and ministries.

### INTRODUCTION TO HERMENEUTICS: HOW TO INTERPRET THE BIBLE

An introductory course on the principles for interpreting Scripture. It summarizes the need for hermeneutical principles and explores the qualifications, tools and goals of a biblical interpreter. This is followed by a historical survey of hermeneutics from early Jewish interpreters to the present. The course includes a unit on the general and specific principles for interpreting the Bible, a unit on genres, and a unit on applying the principles. Students develop their skills by practicing the principles in exercises that are provided.

### NEW TESTAMENT SURVEY

A survey course giving the student background for understanding, teaching and applying the principles of the New Testament. Key facts from each book of the New Testament are highlighted in a manner that can be used in preaching and teaching.

## **OLD TESTAMENT SURVEY**

A practical approach to the Old Testament, this course gives students material they can use in teaching and preaching. It covers significant details from every book in the Old Testament in an inspirational, yet informative manner.

## **ROMANS: JUSTIFICATION BY FAITH**

An in-depth study of the book of Romans. It focuses on Paul's systematic explanation of the gospel to the Romans and offers insight into the doctrines of sin, salvation and sanctification. The student will learn how union with Christ and the indwelling Holy Spirit leads to spiritual growth.

## **THE CORINTHIAN EXPERIENCE**

A challenge to apply the truths of 1 and 2 Corinthians to the student's own life. This course considers Paul's response to the problems that afflicted the Corinthian church, examines the appropriate operation of the gifts of the Spirit within the congregation and familiarizes students with Paul's views of Christian character and ministry.

## **THE PENTATEUCH**

A study of Genesis, Exodus, Leviticus, Numbers and Deuteronomy with a practical approach that will provide preaching and teaching material. The Pentateuch forms the foundation upon which the New Testament covenant is based and is an important study for anyone wishing to understand the entire Bible more completely.

## **THE POETIC BOOKS**

A study of the five books of poetry or wisdom - Job, Psalms, Proverbs, Ecclesiastes and Song of Solomon. These books cover issues like suffering, parenting and the fear of the Lord, and teaching us how to live. The course is designed to help the student in his or her own walk with God and in ministering to others who need instruction.

## **THEOLOGY/HISTORY DIVISION**

### **INTRODUCTION TO PENTECOSTAL DOCTRINE**

An examination of the four cardinal doctrines of the Assemblies of God: Salvation, Baptism in the Holy Spirit, Healing and the Second Coming of Christ. After an introductory unit on the importance of doctrine, there is a unit of study on each of the doctrines. This course is essential to the further understanding of the complete Pentecostal message as presented in other courses.

### **ASSEMBLIES OF GOD HISTORY, MISSIONS AND GOVERNANCE**

A study of the historical development of the Assemblies of God, the history of the missions movement in the Assemblies of God, and the ecclesiastical governance of the Fellowship. Attention is given to the General Council Constitution and Bylaws in relation to credentialed ministers, local churches and district councils.

## **INTRODUCTION TO THEOLOGY: A PENTECOSTAL PERSPECTIVE**

A study of historic Christian doctrines as expressed through Protestant and evangelical traditions. The course provides a complete study of the “Statement of Fundamental Truths” of The General Council of the Assemblies of God.

## **ESCHATOLOGY: A STUDY OF THINGS TO COME**

A biblical study of end-time events written from a Pentecostal perspective. The course studies the Rapture, plus various views of the Tribulation and Millennium. It provides excellent material for teaching and preaching on the Second Coming of Christ.

## **PRAYER AND WORSHIP**

An exploration of the scriptural foundations and spiritual dynamics of individual and corporate praise and worship. The course examines the theological basis and practical implications of music as it relates to the planning and implementation of the contemporary worship service and includes application of the biblical principles of worship through small group participation, observation and leadership opportunities.

## **MINISTRY/PRACTICAL THEOLOGY DIVISION**

### **THE LOCAL CHURCH IN EVANGELISM**

The local church is the provenance of evangelism for reaching its community and the world. After a foundational, biblical theology of the Great Commission and the Holy Spirit’s role in evangelism, this course proposes a comprehensive and integrated approach to evangelism in the local church that avoids over-compartmentalizing evangelism and discipleship. It focuses on variety of evangelism methods, the evangelistic purpose of an organized fellowship of church, and pastoral leadership in evangelism. The largest portion of the course is devoted to the evangelistic responsibility of all believers and practical biblical instruction concerning effective personal evangelism.

### **RELATIONSHIPS AND ETHICS IN MINISTRY**

A biblical approach to the relationships that are important to the minister, both personally and professionally. It looks at temperament theory and its relevance to human relations. This course examines relationships and ethics in view of the minister’s personal growth, ministry challenges, people in the community and other ministers.

### **INTRODUCTION TO HOMILETICS**

A basic study of the principles of Christian preaching. The course emphasizes biblical exposition and deals with practical matters such as the preparation of sermons, the variety of sermon types and the delivery of sermons.

## **EFFECTIVE LEADERSHIP**

A biblical approach to the principles of leadership. This course applies those principles in the church setting, giving the student the practical skills needed to serve in a leadership role in the local church

## **INTRODUCTION TO AG MISSIONS**

An introductory course in the science of missions. It is a survey of the theology, history and methods of Christian missions in general and within the Assemblies of God. There is a special emphasis on recent developments, crucial issues, current trends and missions as they are carried out through national and local churches.

## **CONFLICT MANAGEMENT**

A biblical approach to conflict resolution. This course offers a scriptural way to deal with the inevitable occasions when conflict arises, particularly in a church setting. It offers practical principles for resolving the conflict in a manner that is pleasing to God.

## **PREACHING IN THE CONTEMPORARY WORLD**

The principles, processes and problems of communicating from one culture to another. The course focuses on the development of attitudes and methods that enable effective communication of the gospel to people in other churches.

## **CHURCH ADMINISTRATION, LAW, AND FINANCE**

A study of American church law for ministers, church administrators and ministerial students. The course addresses contemporary legal questions with accurate, up-to-date answers.

## **APOLOGETICS: UNDERSTANDING AND DEFENDING YOUR FAITH**

A philosophical study of the evidential basis for Christian faith. This course helps students to explore the relationship between faith and reason and to develop a reasoned defense of the Christian worldview against rivals such as naturalism and humanism.

## **PASTORAL MINISTRY**

This course examines the ministry of the pastor in three areas: preparation, responsibilities and relationships. In the unit on preparation, we study a pastor's qualifications, devotional life and personal life. A unit on responsibilities analyzes a pastor's role in preaching and teaching, worship, pastoral care, leading, training, forming cell groups and special services. The final unit examines a pastor's relationships with lay leaders, staff, work and calling. This is a principle-centered study to lay a lifelong foundation for the pastoral ministry.

# INTERNSHIP DIVISION

## BEGINNING MINISTERIAL INTERNSHIP

The first of three internships to be developed for the Ministerial Studies Diploma. Each internship will require the student to work with a local pastor to gain hands-on experience in various ministry activities. This course discusses the importance of a good attitude in ministry as well as many of the functions of ministry such as weddings and funerals. It also emphasizes servant leadership and the minister's devotional life.

## INTERMEDIATE MINISTERIAL INTERNSHIP

The second of three required internships for the Ministerial Studies Diploma, this course helps the student develop the right attitude for ministry. It examines characteristics to be avoided and tests to be passed in the life of a minister. It further focuses on public aspects of ministry, such as teaching, preaching and leading meetings. The personal life of the minister, including time management and personal health, are also discussed.

## ADVANCED MINISTERIAL INTERNSHIP

Building on the foundation of the previous two internship courses, this course focuses on three attributes of the heart of ministry, characteristics to be avoided, tests that must be passed in the life of the ministry, basic areas of pastoral counseling and other skills needed to be a successful pastor.

# EDUCATIONAL REQUIREMENTS FOR CREDENTIAL APPLICANTS

## CERTIFIED MINISTER

- Introduction to Hermeneutics: How to Interpret the Bible
- Introduction to Pentecostal Doctrine
- Christ in the Synoptic Gospels
- Prison Epistles: Ephesians, Colossians, Philippians and Philemon
- Acts: The Holy Spirit at Work in Believers
- The Local Church in Evangelism
- Assemblies of God History, Missions and Governance
- Relationships and Ethics in Ministry
- Beginning Internship

## LICENSE

- Introduction to Theology: A Pentecostal Perspective
- New Testament Survey
- Old Testament Survey
- Romans: Justification by Faith
- Introduction to Homiletics
- Eschatology: A Study of Things to Come
- Leadership Skills
- Conflict Management
- Introduction to AG Missions
- Intermediate Internship

## ORDAINED

- Prayer and Worship
- The Corinthian Correspondence
- The Poetic Books
- The Pentateuch
- Preaching in Cultural Context
- Church Administration, Law and Finance
- Cults, World Religions and the New Age Movement
- Pastoral Ministry
- Advanced Internship

# 2012-2013 ACADEMIC CALENDAR

**2012**

**OCTOBER 5-6**

Certified Minister  
License to Preach  
Ordained

Relationships and Ethics  
Introduction to Homiletics  
Prayer and Worship

**NOVEMBER 2-3**

Certified Minister  
License to Preach  
Ordained

AG History, Missions and Governance  
Eschatology  
Apologetics

**NOVEMBER 30- DECEMBER 1**

Certified Minister  
License to Preach  
Continued Education

Local Church in Evangelism  
Introduction to Missions  
TBA

**2013**

**JANUARY 4-5**

Certified Minister  
License to Preach  
Ordained

Introduction to Pentecostal Doctrine  
New Testament Survey  
Pastoral Ministry

**FEBRUARY 1-2**

Certified Minister  
License to Preach  
Ordained

Introduction to Hermeneutics  
Romans  
Pentateuch

**MARCH 1-2**

Certified Minister  
License to Preach  
Ordained

Acts  
Introduction to Theology  
Church Administration, Law & Finance

**MAY 17-18**

Certified Minister  
License to Preach  
Ordained

AG History, Missions and Governance  
Conflict Management  
1 & 2 Corinthians

**JUNE 21-22**

Certified Minister  
License to Preach  
Ordained

Prison Epistles  
Old Testament Survey  
Poetic Books

**AUGUST 23-24**

Certified Minister  
License to Preach  
Ordained

Synoptic Gospels  
Leadership Skills  
Preaching in Cultural Context

# ISOM BOARD OF ADMINISTRATION

## CHAIRMAN: REV. TOM JACOBS

Rev. Tom Jacobs holds a Bachelor's degree in Biblical Studies from Oral Roberts University in Tulsa, Oklahoma. He currently serves as the Superintendent of the Iowa Ministry Network. Tom has served as a Sectional Presbyter, Executive Presbyter, and senior pastor at Morningside Assembly in Sioux City. He also serves as a General Presbyter for the General Council of the Assemblies of God. Tom and his wife Lori have a married daughter, Ashley (Nick) Knepper, a son, Austin, and a grandchild arriving this winter.



## PRESIDENT: REV. GARY PILCHER

Rev. Gary Pilcher received a diploma from Ozark Bible Institute and College and has a Master of Arts in Christian Ministries from the Assemblies of God Theological Seminary. He has served as a youth pastor, a home missions pastor and as a senior pastor of LifePointe Church in Ames and Berean Assembly of God in Des Moines. Gary has served the Iowa Ministry Network in a variety of roles and currently serves as the Iowa Ministry Network Assistant Superintendent and as a General Presbyter of the General Council of the Assemblies of God. Gary and his wife Carol have two married daughters, Crystal (Justin) Wirtz, Tiffani (Jeremy) White, a son, Caleb, and two grandsons.



## REGISTRAR: REV. CARY VAN KAMPEN

Rev. Cary Van Kampen has a Bachelor's Degrees from Evangel University in Physical Education and Bible, a Master's Degree in Secondary Athletic Administration from Drury University and holds a lifetime teaching certification. Cary has served in a variety of ministry and education roles. Currently, Cary serves as the Network Administrator for the Iowa Ministry Network. Cary and his wife Wanda live in Pella and have two children Charlie (Tomi Jo) and Emily (Christopher) Orr who all attend Evangel University.



 iowa ministry network



# iowa ministry network

10525 BUENA VISTA COURT URBANDALE, IA 50322

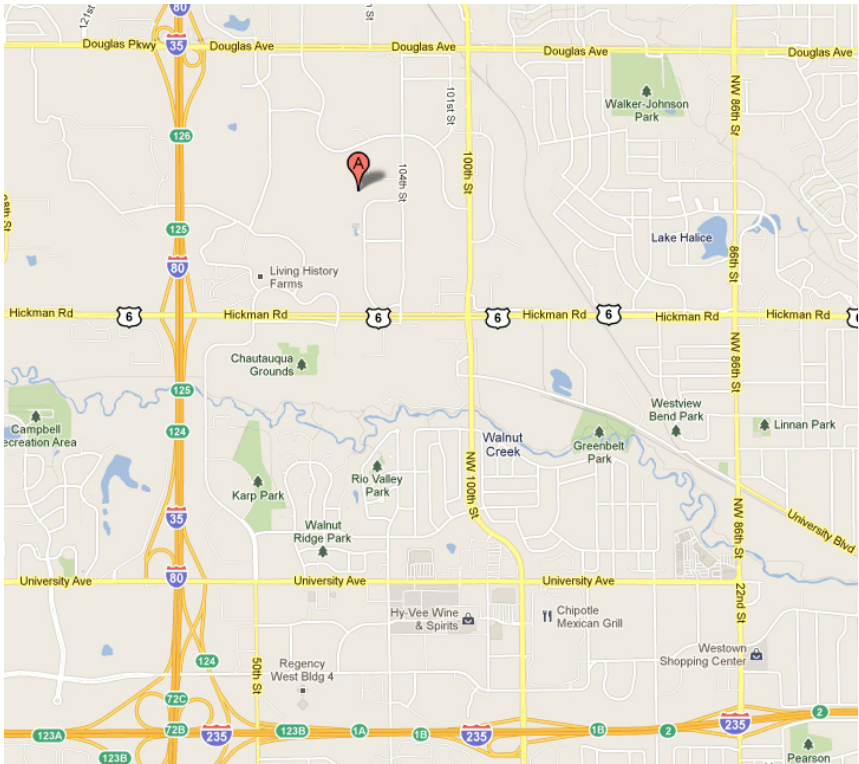

# ISOM TESTIMONIES

ISOM has given me the opportunity to be both academically and spiritually challenged. The relationships that have been forged through the ISOM experience, with both the instructors as well as classmates, have been one of the greatest resources to both my ministry and to me personally.

JOHN LYNN  
LEAD PASTOR  
CROSSPOINTE CHURCH  
DYSART, IA

ISOM has been a great experience for me as I have been working on my required licensing and ordination classes. The course study, leadership and fellow students have challenged and encouraged me. I would recommend ISOM for anyone wanting to grow in the knowledge of the Lord and in leadership skills.

CINDY SAAK  
PRAYER COORDINATOR  
NEW LIFE ASSEMBLY OF GOD  
REINBECK, IA

The flexibility that ISOM provided made it easy for me to study on my own time. The experience of the instructors made the classes very interesting and practical. The interaction with the other students makes the overall ISOM experience incredible!

BRAD THOMAS  
IMN BUSINESS ADMINISTRATOR  
DES MOINES, IA

ISOM helped me stay focused. And the camaraderie of others in the class is so important! Each month the same faces are there, and we're all going through this together.

MATT LOOMIS  
LOOMIS SAFETY & CONSULTING  
IMN YOUTH ALIVE DIRECTOR  
DES MOINES, IA

EQUIPPING SPIRITUAL  
LEADERS THROUGH  
ACADEMIC DEVELOPMENT  
AND ENCOURAGING  
RELATIONSHIPS

 iowa ministry network