

Iron Newel

Installation Instructions with the MB IRON Metal Newel Fastener and the 06N 1-1/4" Flat Shoe

IMPORTANT: Please read instructions thoroughly before beginning.

The following instructions are designed to be used for the installation of our Iron Newel Posts into a wood surface.

TRIM THE NEWEL TO LENGTH

Determine the newel length above the tread. Add 6 1/4" to the measurement for insertion into the newel mounting sleeve. Transfer the total measurement to the newel post. If the newel needs to be trimmed to length, trim off the bottom using a metal cutting chop saw or portable band saw. Be sure to seclude your work area as hot sparks from a metal cutting chop saw can damage nearby windows, flooring, walls, etc. (A).

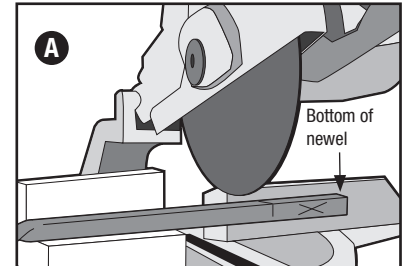

PREPARE THE MOUNTING SURFACE

Step 1. If an iron newel will be installed in a starting step, refer to our Starting Step Installation Instructions to be sure the starting step is securely installed.

Before securing the starting step tread to the riser, see Step 2 below.

Step 2. Locate and mark the newel centerpoint on the tread. Outline a 1-1/2" square centered around the centerpoint (B). Drill a 1" hole through the tread and any blocking material (C). Use a jig saw to cut out the 1-1/2" square outline (D). Before attaching the tread, cut blocking material using a sabre saw or sawzall (E).

Step 3. Slide the newel mounting sleeve (MB IRON) completely down into the hole until the top rim is flat on the mounting surface and mark the anchoring screw locations. Remove the sleeve and predrill the mounting surface for each screw location (F).

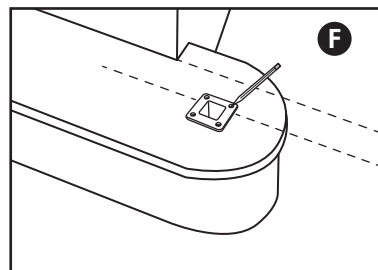
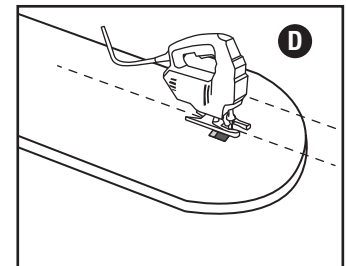
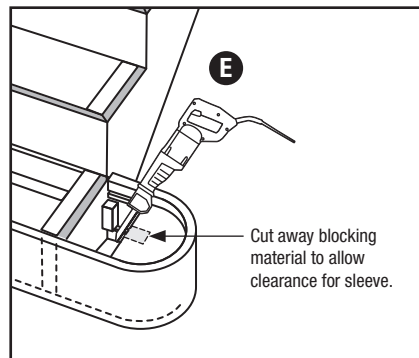
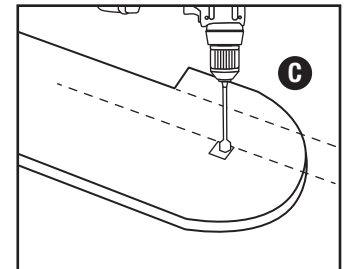
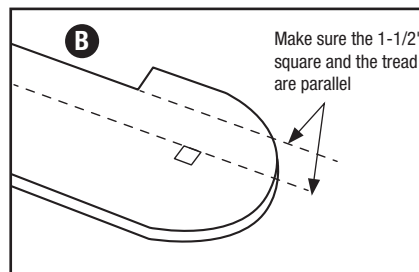

06N Flat Shoe

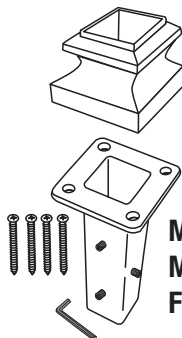

MB IRON
Metal Newel
Fastener

Iron Newel

Installation Instructions with the MB IRON Metal Newel Fastener and the 06N 1-1/4" Flat Shoe

SECURE THE IRON NEWEL POST

- Step 4.** Slide the **06N Flat Shoe** over the bottom of the newel and slide the newel post into the newel mounting sleeve until the newel is flush with the bottom of the sleeve (G). Using an allen wrench, tighten the 3 set screws into the side holes of the sleeve.
- Step 5.** Slide the sleeve (with newel) completely down into the hole until the top rim is flat on the mounting surface (H).
- Step 6.** Slide the flat shoe up and permanently attach the sleeve to the tread using the 3" anchoring screws (I). We recommend using a flexible drill shaft for this step.
- Step 7.** Use our two-part epoxy adhesive on the bottom of the flat shoe to secure it to the tread. When using two-part epoxy, be aware of cure times. Construction adhesive may also be used (I).

